

Oatena

#3593

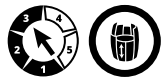
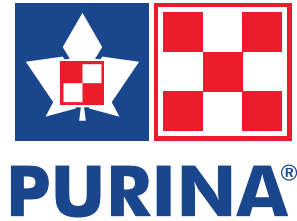

Guaranteed Analysis

Protein	13.00%
Fat	4.00%
Fibre	12.00%
Calcium	0.60%
Phosphorus	0.40%
Sodium	0.45%
Vitamin A	6500 I.U./kg
Vitamin D3	1200 I.U./kg
Vitamin E	220 I.U./kg
Selenium	0.30 mg/kg

Directions for use

Purina Oatena is recommended for the active leisure horse. Feed according to the following table. Individual horses may require feeding rate adjustment of plus or minus 15% of amount indicated.

Daily amount | kg

Horse Weight	300	400	500	600
Min. hay or equivalent pasture/horse/day	3.0	4.0	5.0	6.0
Purina Oatena	2.3	2.5	2.8	3.0

A versatile textured feed for the active leisure horse, it is ideal for boarding stables and riding schools.

Oatena is formulated with certified quality ingredients and is manufactured exclusively in our specialized and drug-free facility in Strathroy, Ontario.

Characteristics

CHARACTERISTICS	ADVANTAGES
Uses high quality ingredients	<ul style="list-style-type: none"> Highly palatable feed.
Convenient and versatile	<ul style="list-style-type: none"> Suitable for many types of horses. Ideal for the maintenance horse, the leisure horse and the active horse.
Available at a competitive price	<ul style="list-style-type: none"> Excellent value.
Contains balanced amino acids with added Lysine & Methionine	<ul style="list-style-type: none"> Provides building blocks for improved muscle and joint development.

Ingredients

Fibre	Soya Hulls
Protein/Amino Acids	Soya Bean Meal, DL-Methionine, L-Lysine
Starch	Ground Wheat, Whole Grain Oats, Flaked Barley
Fat	Soy Oil
Prebiotic	
Probiotic	
Vitamins	Vitamin A, Vitamin D3, Vitamin E, Vitamin K, Riboflavin, Niacin, Thiamine, Vitamin B12, Biotin, Choline Chloride
Minerals	Salt (Sodium Chloride), Calcium Carbonate, Cobalt Carbonate, Calcium Iodate, Copper Sulphate, Ferrous Sulphate, Manganese Oxide, Zinc Oxide, Organic Selenium
Multi-Attributes	Wheat shorts
Flavour/Binder	Molasses, Pellet Binding Agent

* Ingredients are not in order of their inclusion rate.

1. Purina recommends that you have your hay analyzed and balance your ration accordingly.
2. Do not provide more than 0.5% of Body Weight of this feed at one time.
3. Provide a source of fresh, clean water at all times.
4. Follow sound management practices along with disease and sanitation control measures. If there are any questions, contact your veterinarian, Purina dealer or Purina sales consultant.

Caution

Directions for use must be carefully followed.

Feed is perishable. Store in a dry, well-ventilated area protected from rodents and insects. Do not feed moldy or insect-infested feed to animals as it may cause illness, abortion or death.

Oatena

#3593

